

* EASY TO DISMANTLE FOR CLEANING

* CONTROLLABLE SLIP FLOW

* RUBBER OUTLET NOZZLE PREVENTS MOULD DAMAGE

- EASY TO MAINTAIN—ALL SPARES AVAILABLE
- AVAILABLE

STAINLESS FILTER MESH CG 23 (OPTIONAL EXTRA)
(PUSH FIT INTO OUTLET NOZZLE CG 22)

(Helps prevent pin-holing)

•

HAND CASTING TAP

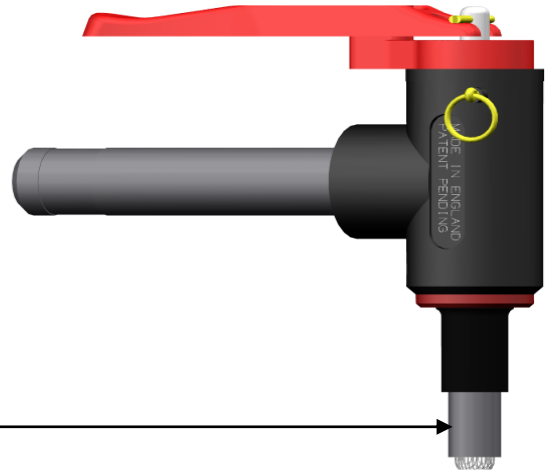

Used for over 25 years by porcelain, china and earthenware manufacturers i.e Aynsley China, Beswick, Coalport China, Royal Doulton, Spode, Josiah Wedgwood and many more. We also produce a casting tap suitable for sanitary ware and large hollow-ware casting REF' L V 32 which accepts 1 1/4" (32mm) bore supply hose giving approx 50%---60% more casting-slip flow.

SPARE PARTS DESCRIPTION

- CG 13-----SPILT PIN AND RING
- CG 15----- PIVOT PIN
- CG 16-----HANDLE
- CG 18-----SPINDLE HOUSING
- CG 19-----SPINDLE ASSEMBLY
- CG20-----SPRING
- CG21-----VALVE CONE (rubber)
- CG22-----OUTLET NOZZLE (rubber)
- CG 23-----FILTER NOZZLE WITH STAINLESS STEEL

INLET TUBE (3 SIZES)

L.S 1 --SUITS 3/4" BORE (20 mm) SUPPLY TUBE

L.S 2 --SUITS 1" BORE (25 mm) SUPPLY TUBE

L.S 3 --SUITS 1 1/4" BORE (32 mm) SUPPLY TUBE

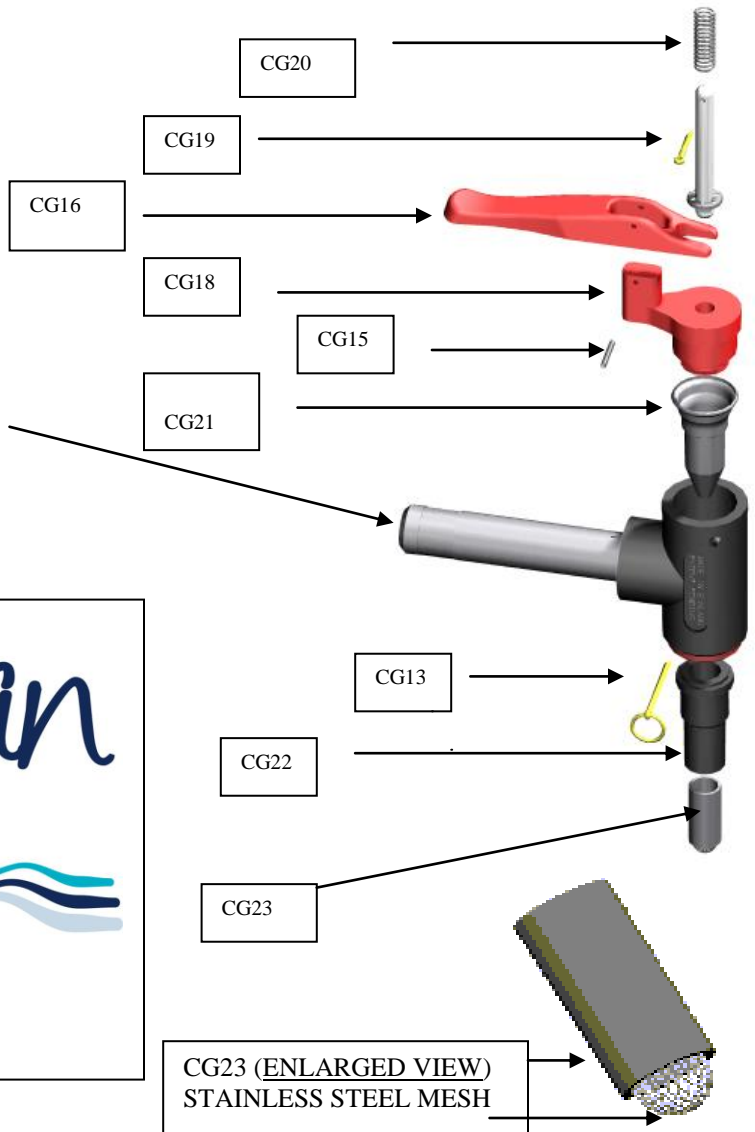

HYGAN PRODUCTS LIMITED
 REGISTERED OFFICE: KINGS CROFT WORKS, STOKE OLD ROAD, HARTSHILL,
 STOKE-ON-TRENT, ST4 6ES UK, TEL 00 44 (0) 1782 613936, FAX 00 44 (0) 1782 711614
 REGISTERED IN LONDON, UK. NO. 736011 V.A.T. REG. NO. GB 278 7253 17
 E.MAIL sales@hygan.com Web: www.hygan.com